



Huisman Adopts ZWCAD to Design and Produce Reliable Construction Equipment

Huisman

INDUSTRY

Heavy Construction Equipment

PRODUCTS

Cranes, pipelay systems, drilling equipment, etc.

WEBSITE

www.huismanequipment.com

🔍 CHALLENGES

- Unify the 2D CAD software used throughout the production chain
- Spread the new CAD program without time-consuming training
- Increase design precision to create more reliable products

🔧 SOLUTION

ZWCAD

✅ RESULTS

- Production and collaboration are more efficient when the same CAD program is used
- Staff with various levels of CAD knowledge get the hang of it shortly
- Engineering drawings are modified to be more accurate and reviewed quickly

Founded in 1929, Huisman provides professional technical solutions to the world's leading companies in the oil & gas, renewables, leisure, and civil industries. Its products mainly include cranes, pipelay equipment, drilling equipment, winches, vessel designs, and special projects.



Enjoying the reputation for being a trustworthy partner, Huisman attributes its success to its quality and innovative products. Since they are often the critical equipment in all kinds of operations, Huisman attaches significance to the software they are designed with.

Searching for an Intuitive and Powerful CAD Tool

The production chain of Huisman can be roughly divided into five parts where CAD drawings are involved. Therefore, unifying the CAD software they use is necessary for higher production and collaboration efficiency.

However, it was challenging to apply the same program throughout the company because the CAD skill levels of employees differ. So, finding an intuitive CAD tool is crucial. Meanwhile, it should be powerful enough to meet the demanding needs of designers and engineers. After thoroughly testing out ZWCAD, Huisman decided that all departments adopted this easy-to-use and practical software.

Maximize Quality and Productivity with One Tool in Five Steps

Step 1: Requirement Confirmation

According to Ada, a sales engineer, she needs to communicate with clients first to understand their requirements. Now that the company has chosen the fully DWG compatible ZWCAD, she can quickly open the files from clients and get the essential information of various mechanical parts, such as dimension and weight.

Step 2: Design Customization

Then, requests and engineering drawings will be sent to work preparation engineers like Bob for highly precise customization. By measuring the unspecified parts with ZWCAD, Bob can enrich the drawings with assorted dimensions. He can also rapidly modify legacy drawings with its handy functions. Seeing that ZWCAD can help him avoid even the tiniest dimension error which might lead to a serious defect in the latter production and operation, Bob thinks highly of its functionality and reliability.

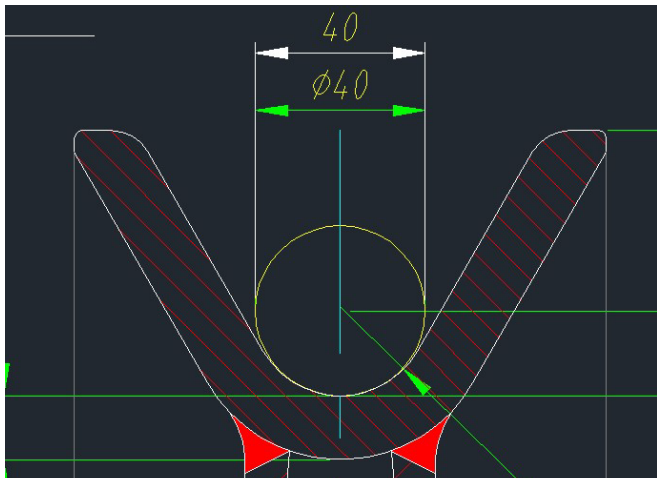

“ I am a faithful ZWCAD user, and I have been working with ZWCAD for several years. I can easily create or modify the drawings with it. ”

— Bob, Work Preparation Engineer

Step 3: Material Coordination

After that, Yang, assistant of the material supervisor, would view, check, and plot the drawings to organize the needed materials. At this stage, efficiency is his priority. By quickly handling the drawings with ZWCAD, he can save more time for the following production work.

Step 4: Manufacturing

With everything prepared, Lance the supervisor of fitting starts guiding the production with the engineering drawings. To manufacture the highly sophisticated equipment, multiple sub-divided groups must collaborate seamlessly together. For example, the production-painting group uses ZWCAD to annotate the parts that need particular treatments, and then, the welders open the drawings and check the detailed information with ZWCAD to do the welding accordingly.

Step 5: Quality Test

Finally, Betty, the NDT (nondestructive testing) operator, and her colleagues are responsible for ensuring the reliability of their products. “I use ZWCAD all the working day. It’s simple and convenient”, said Betty who opens and checks the relevant production drawings carefully. After the rigorous quality control, the final industry-standard products are ready.

A Reliable Choice Ensures Product Quality

Through the above small piece of the whole sophisticated production picture, it is clear why Huisman is recognized as a reliable supplier of heavy construction equipment. Trusted by Huisman, ZWCAD shows great compatibility, functionality, and reliability to help them produce excellent equipment for different industries.



ZWSOFT

ZWSOFT is a reliable and innovative provider of engineering software with flagship products ZWCAD and ZW3D. With over 20 years of experience in the industry, our products and services have been proven by 900,000+ AEC and MFG customers in 90 countries and regions.

📍 32/F, Pearl River Tower, Guangzhou, China
☎ +86-20-38289780
✉ sales@zsoft.com
🌐 www.zsoft.com